



## Block 21o (09W) Taxiway Rehabilitation

HCNF September 2018

Peter Rafano – Airspace and Noise Performance Manager

**Heathrow**  
Making every journey better

# Block 21o/09W Closure - Impact on **Easterly** Operations

- 09W is a Rapid Exit Taxiway (RET) on the northern runway, used during Easterly ops.
- The area requires major remedial work, that involves digging out the entire area and resurfacing – 2<sup>nd</sup> October to 23<sup>rd</sup> December
- The upcoming Phase 3 works require a full closure of the area. This timeframe was chosen due to lower traffic volumes helping to mitigate the impact on Night Flights.
- Based on historic data, there is a 20% risk of Easterly Operations during the rehabilitation works period
- Unavailability of 09W requires an ATC restriction of 4 mile spacing to maintain safe operations. This is due to aircraft remaining on the runway for longer due to the RET being unavailable.
- This 4 mile restriction mandates an Aircraft Flow Restriction (AFR) of 36 arrivals per hour

# Where is 21o (A9W)

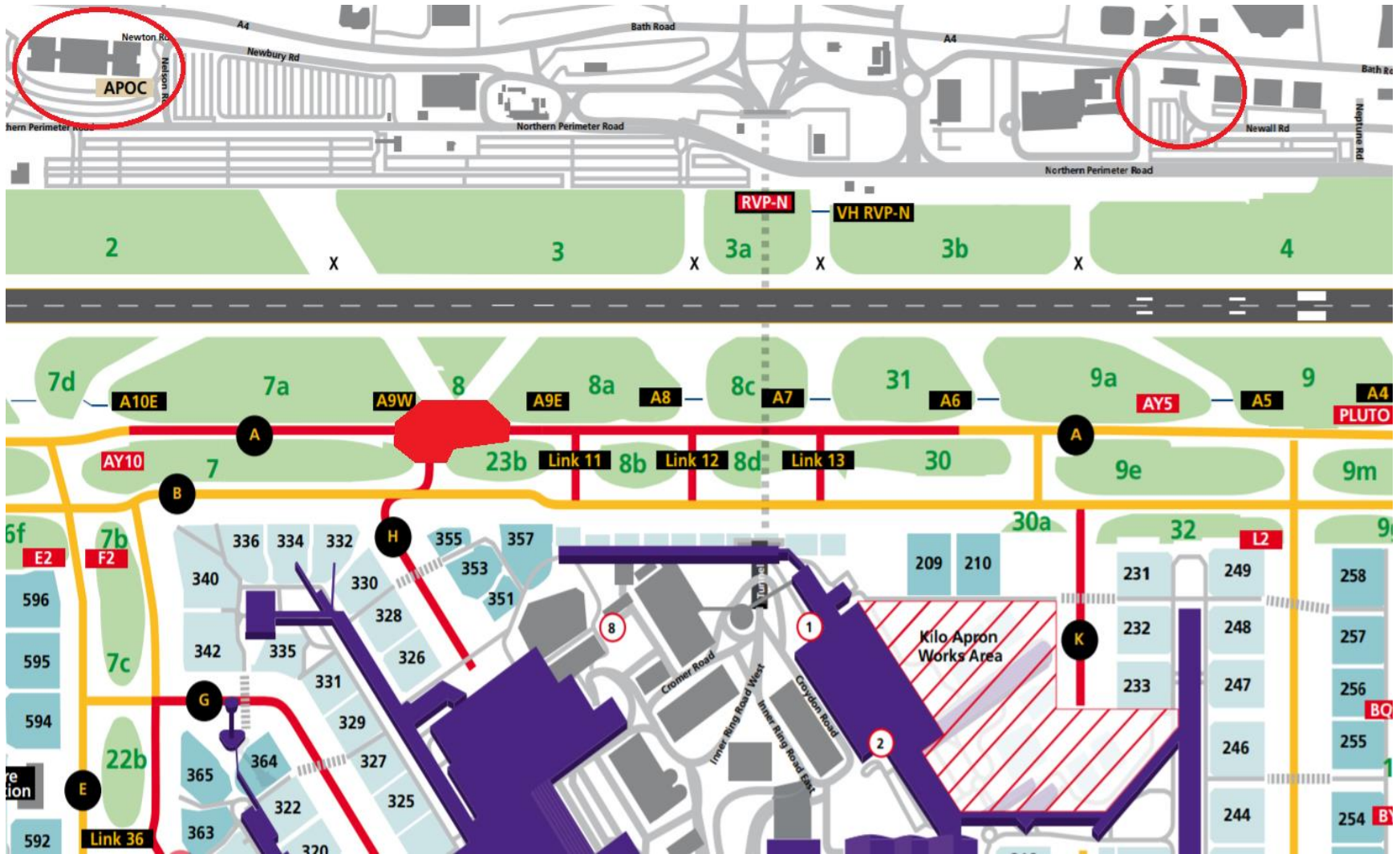

# Mitigating the impact on Easterly Ops

- Modelling analysis shows that no intervention will result in a disrupted schedule
- Modelling completed using the **worst case** peak October traffic numbers over the last 5 years
- Modelling impact assessment completed using new Demand Capacity Balancing (DCB) tool and compared with ADDICT
- Acceptable margins indicated between both tools providing high confidence in outputs
- Heathrow's mitigation measure is to apply TEAM throughout the operational day: (an additional 2 aircraft per hour) on **Easterlies only**
- This means landing an extra 2 aircraft per hour on the southern runway from 0700

# Heathrow

*Making every journey better*